

Key Features:

- 2 Hours Fire Rated
- Acoustically Rated to 67dB
- Air Leakage tested
- Made from Fire Resistant Fibre
- Ready to install; no moulding or trimming required



Internal walls create the required barriers to air leakage, fire and acoustic transmission. However, once a hole is made in the wall for a recessed switch or socket box, the ability of the wall to protect against air leakage, fire and acoustic transmission is significantly reduced.

To combat this **TENMAT** has developed the Fire and Acoustic Rated FIREFLY 130 Socket Box Inserts. The FF130 Socket Box Inserts have been developed to improve air tightness and maintain fire and acoustic protection for penetrations created by the introduction of both single and double recessed socket boxes. The fire resistant mineral fibre Socket Box Insert limits the passage of fire and smoke through the wall.

Availability

Name	Socket Type	Depth
FF130 Socket Box Inserts	Single	35mm, 47mm
FF130 Socket Box Inserts	Double	35mm, 47mm

Fitting Instructions

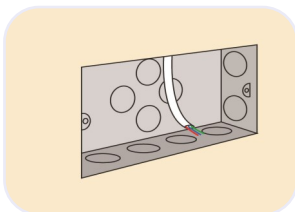

- Make small, tight fitting hole through Insert, ready for cable

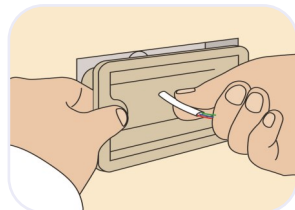

- Pass cable through Insert and fit Insert into socket box

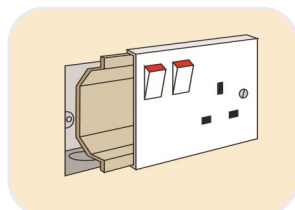

- Fit socket cover as normal. Screws can pass through Insert material
- The flange of the Insert should be hidden by the socket cover. Any rough edges can be trimmed